

FS-I-Z

- Plain
- Flap
- Ball
- Spinner
- Stainless
- Mica plate
- Protective wire mesh
- With protective cover



■ Features

1. The absence or presence of fluid or color of fluid can be checked due to the transparent plate on both sides.
2. Excellent visibility by internal nozzle structure at the time of vertical piping.

■ Specifications

Application	Cold and hot water, Oil	
Maximum working pressure	0.7 MPa	
Max. temperature	60°C	
Material	Body	Ductile cast iron
	Glass	Hardened glass
	Nozzle	Brass
Connection	JIS Rc screwed	JIS 10K FF flanged

■ Dimensions (mm) and Weights (kg)

· Screwed type

Nominal size	L	H	S	P	Weight
10A	100	74	40	71	0.9
15A	100	74	40	71	1.0
20A	110	92	46	78	1.4
25A	120	94	52	84	1.8
32A	150	132	70	110	4.0
40A	150	132	70	110	4.0
50A	160	142	70	110	7.5

· Flanged type

Nominal size	C	D	H	S	P	L	Weight
10A	65	90	80	40	80	160	3.0
15A	70	95	80	40	80	160	3.0
20A	75	100	100	46	88	180	3.9
25A	90	125	102	52	96	180	5.4
32A	100	135	140	75	120	180	8.0
40A	105	140	140	75	120	180	8.0
50A	120	155	150	80	128	220	11.0

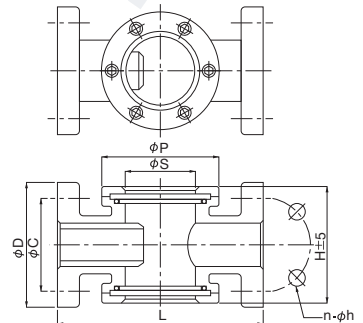
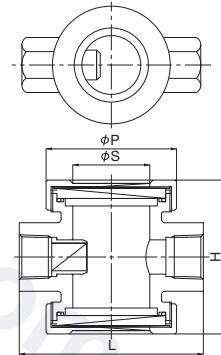

Please fill in the usage conditions on the specification sheet on P.7-12 when ordering.