

VB-7,7S



■Features

1. Protects devices and piping by adjusting vacuum and preventing accidents resulting from vacuum pressure.
2. Special valve structure ensures stable performance without chattering and hunting.
3. Compact, lightweight and easy to handle.
4. Made of corrosion resistant material. (VB-7S)

■Specification

Model	VB-7	VB-7S	
Application	Steam, Air		
Working pressure	1.0 MPa		
Pressure regulating range	Spring A	-0.5 to -21 kPa (Standard set pressure: -4 kPa)	
	Spring B	-21 to -48 kPa (Standard set pressure: -21 kPa)	
	Spring C	-48 to -81 kPa (Standard set pressure: -48 kPa)	
Maximum temperature	200°C		
Material	Body	Brass	Stainless steel
	Valve	Bronze	Stainless steel
	Valve seat	Brass	Stainless steel
Connection	JIS R screwed		

■Dimensions (mm) and Weights (kg)

Nominal size	d	H	A	Weight
15A	R 1/2	100.0	35	0.50
20A	R 3/4	100.0	35	0.50
25A	R 1	112.5	41	0.75
32A	R 1-1/4	113.5	50	1.05
40A	R 1-1/2	130.0	55	1.45
50A	R 2	156.5	65	2.45

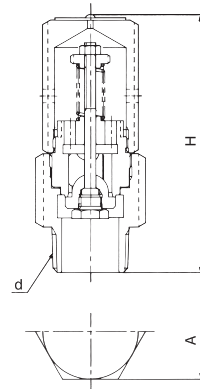

■ Example Piping Diagram

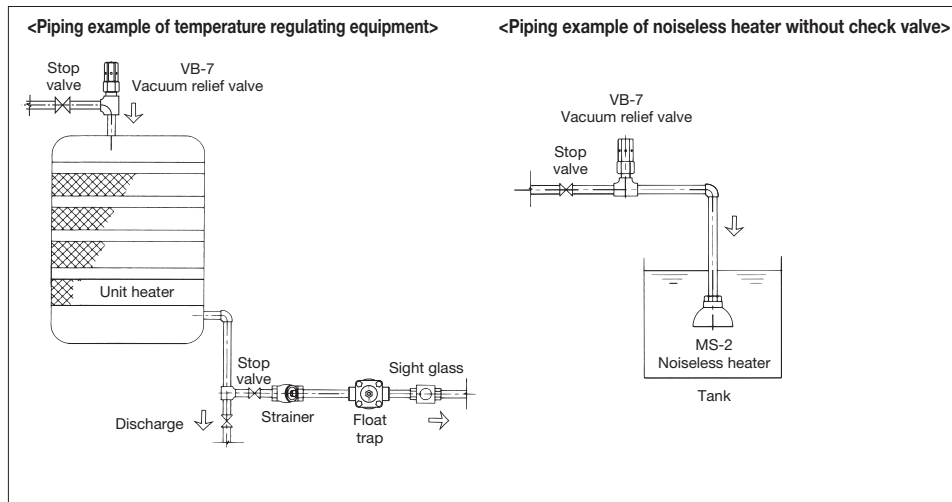

■ Nominal Size Selection Chart

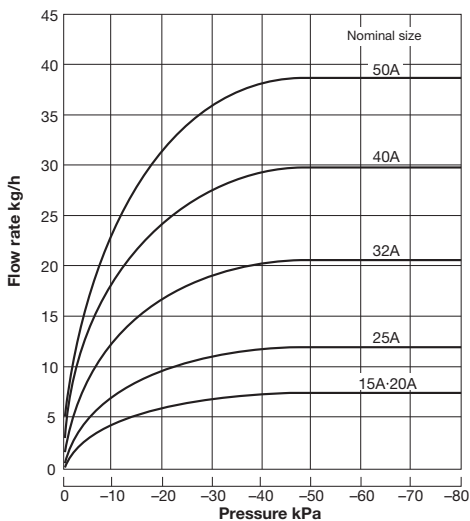

* Flow rate above is for reference only.